

TRIPLUS

Taking an extra-class whirl bath in combination with the unique experience of the Japanese bathing culture. The TRIPLUS system uses several techniques. In the area of the back, a pump whirls back water enriched with air via nine integrated microjets. A second pump supplies the eight laterally arranged nozzles with water, the air supply being controlled by a connectable blower. Finally, sixteen air nozzles arranged in the bottom whirl preheated air into the water in millions of bubbles. This turns a whirl bath into a real treat which you would never miss again.

SYSTEM DESCRIPTION

THE TRIPLUS WHIRL SYSTEM:

- Whirlpool with drain and overflow fittings, incl. bottom suction nozzles, residual water drainage and siphon trap (A)
- Visible parts such as key pads (B), drain and overflow fittings (A), massage nozzles (C, D, E), air mixing controller (F), suction nozzle (G) and underwater spotlight of chromium
- Piping system (H) with 16 nozzles (C) in the bottom area and residual water drainage
- Piping system (I) with 8 massage nozzles in the side area (D) and residual water drainage
- Piping system (J) with 9 massage nozzles with residual water drainage and air mixing controller in the loin area (E)
- Suction nozzle (G)
- Height-adjustable pedestal (K)

ELECTRICAL COMPONENTS TRIPLUS WHIRL SYSTEM:

- 2 key pads with 6 or 7 functions, resp. (B)
- 2 speed-controlled, low-noise pumps (L) for the massage nozzles in the side area and the nozzles in the loin area with a capacity of 950 W/ 800 W
- 2 speed-controlled, low-noise blowers with heating (M) for the nozzles in the bottom area and the massage nozzles in the side area with a capacity of 1100 W each and automatic blow-drying
- Underwater spotlight 12 V/35 W including safety transformer and level sensor

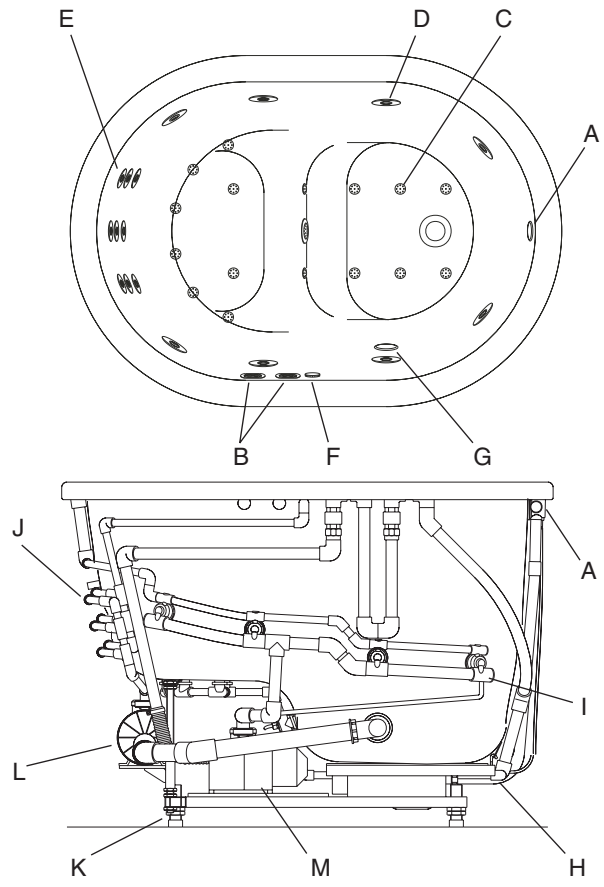

D

GB

F

I

E

Whirl systems

OPTIONAL EQUIPMENT

- Drain and overflow fittings with integrated inlet
- Visible parts such as sealed key pad, drain and overflow fittings, massage nozzles, suction nozzle, air mixing controller and underwater spotlight are available in different colours upon request

TECHNICAL DATA

Power input	3985 W
Nominal input pump (side)	950 W
Nominal input pump (loin area)	800 W
Nominal input blower	2 x 1100 W
Nominal input spotlight (12 V)	35 W
Mains connection	230 V
	50/60cps
	20 A
Safety class	IP65
Lead cross section	3 x 2.5 mm ²
Operation	Sealed key pad

KUSATSU-POOL – TRIPLUS

KALDEWEI

TECHNISCHE INFORMATIONEN

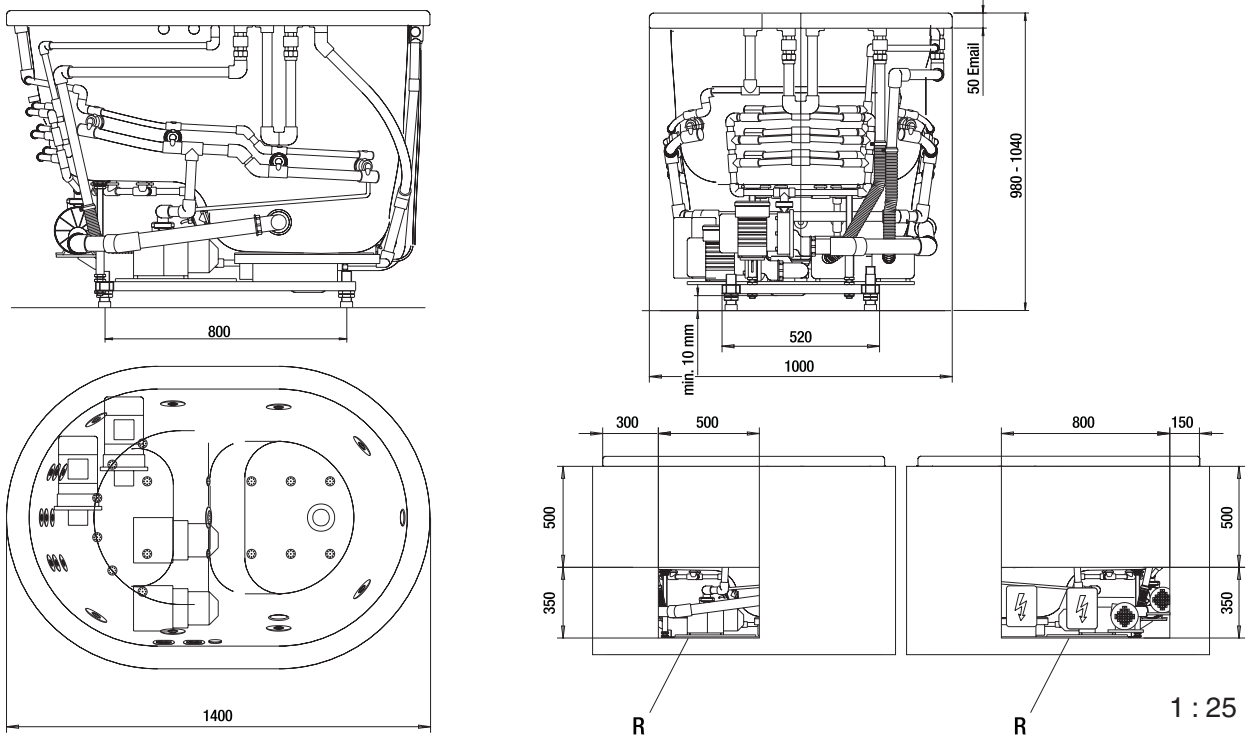

Modell 177
+TRIPLUS
Kaldewei-Email®

	Dimensionen Dimensions	1400 x 1000 x 980-1040 mm
	Gewicht Weight	132 kg
	Füllmenge Capacity	505 l
	Bodenbelastung Floor load	12,7 kg/cm ²
	Bodenbelastung Floor load	539,8 kg/m ²
	Versandgewicht Shipping weight	192 kg
	Versandmaße Shipping dimensions	1600 x 1130 x 1050 mm

Beachten Sie die technische Hinweise (siehe Seite 9 ff.) / Please observe the technical notes (see pages 9 et seq.).
Fertigungstechnische Änderungen und Toleranzen vorbehalten. / Subject to production-related alterations and tolerances.

D

GB

F

I

E

Wannenmodelle/Bathtub models